



Cypress



DISCLAIMER: IMAGES AND RENDERINGS MAY INCLUDE UPGRADES THAT ARE NOT INCLUDED IN STANDARD PRICES.



**Cypress, 2320 Sq Ft +/-, 4 bedroom 2 bath,
392 Sq Ft +/- covered porches, 576 Sq Ft +/- garage**

***Images and renderings may vary from base pricing.
 ***Land improvements such as septic, well, driveway, and sidewalk are not included in standard pricing.
 ***Crawl-space foundations are standard, but built up slabs are an available option.

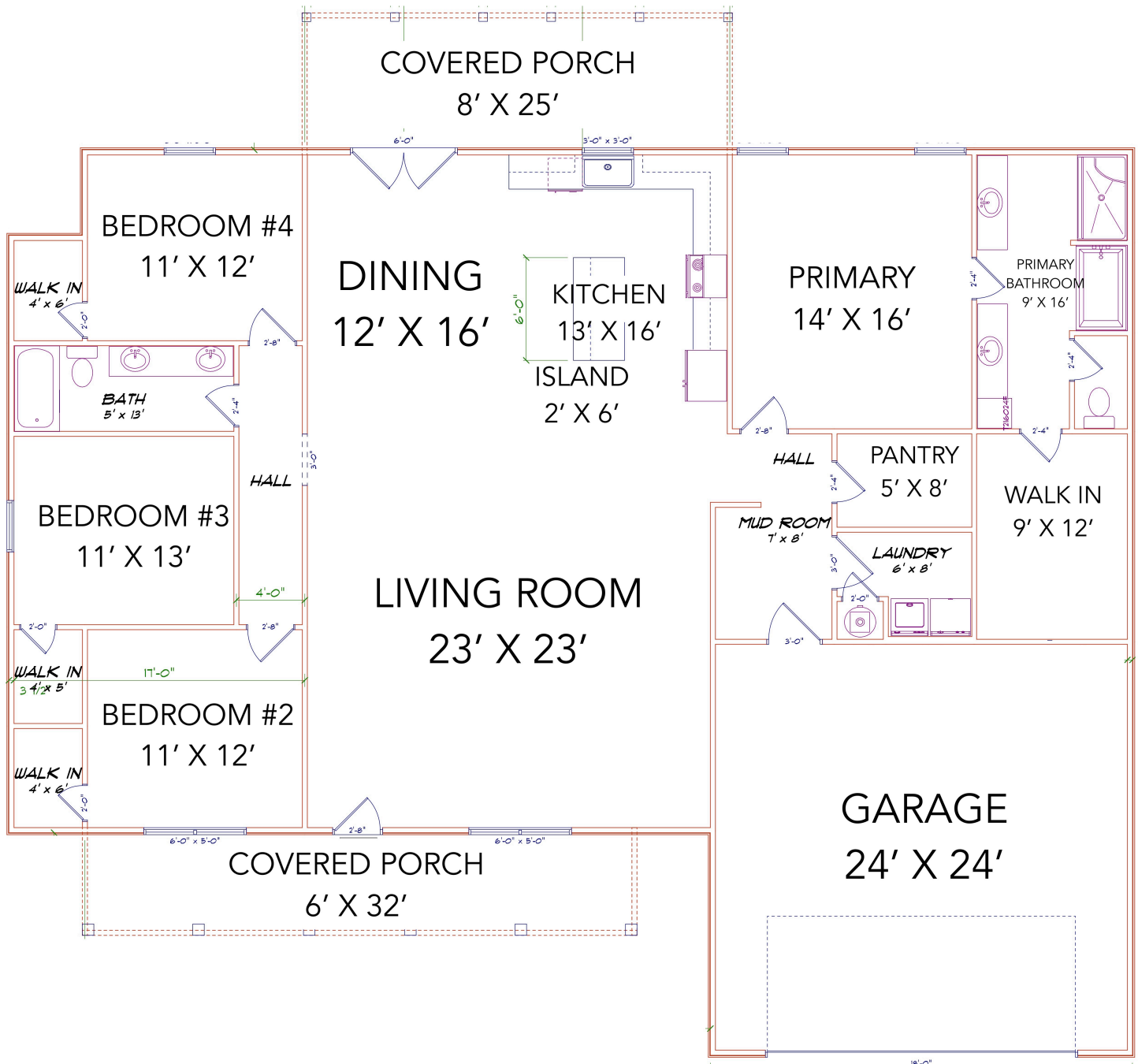

NAME	SIZE
MAIN FLOOR	2320 Sq Ft +/-
GARAGE	576 Sq Ft +/-
COVERED PORCHES	392 Sq Ft +/-
HOUSE DIMENSIONS	65'8" x 60'10.5"

Room dimensions are approximate.
 Precise room dimensions provided by a draft for construction.